

**468 SF  
OFFICE SPACE**

**NAI Commercial**



**Suite 601 - 1080 Howe Street | Vancouver, BC**

## **FOR LEASE**

### **Downtown Vancouver Executive Place Tower**

Opportunity to lease 468 SF of fully-improved, premier office space in the heart of downtown Vancouver. Centrally situated at Howe and Helmcken, this building is within close proximity to public transportation, trendy restaurants and is within walking distance to all points on the downtown peninsula.

# Suite 601

## 1080 Howe Street

Vancouver, BC

### Unit Description

Suite 601 is available for lease. The premises is all open plan.

### Highlights

- ▶ Fully-improved space
- ▶ Underground parking
- ▶ Gym, showers, kitchen and common boardroom
- ▶ Double glass door entry to the building
- ▶ Open area with lots of natural light
- ▶ New vinyl plank flooring
- ▶ New paint

### Floor Plan

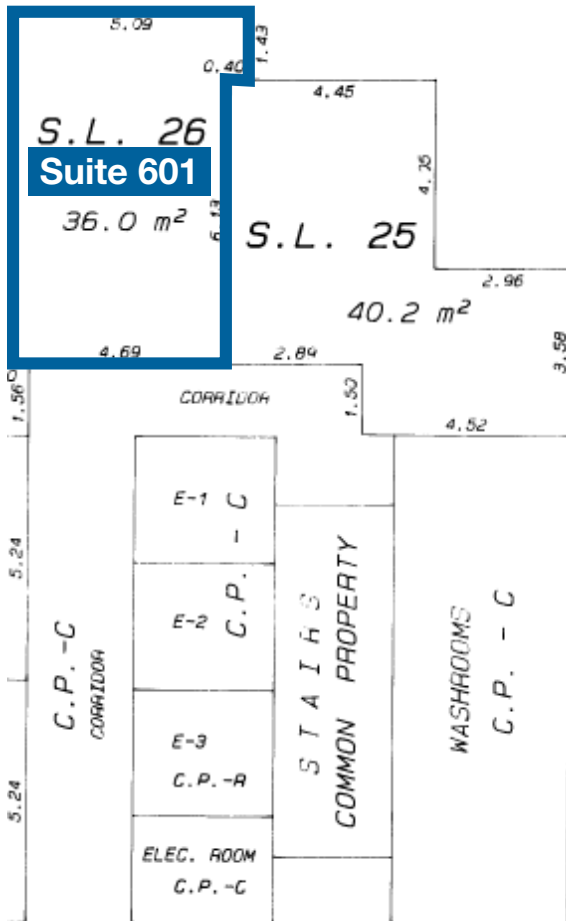

### Property Details

Size  
468 SF

Base Rent  
\$25.00/SF

Operating Cost & Property Taxes  
\$19.52/SF (2022)

Brian Mackenzie  
Vice President Leasing & Sales  
604 691 6618  
bmackenzie@naicommercial.ca

